

## Curved-Face Elegance, Sustainable Engineering

Pacific Exterior™ modular signage system brings a fresh appearance to exterior signage. Combining form, flexibility and function, Pacific Exterior features interchangeable, curved face panels that can be configured to meet your specific needs.

Pacific Exterior can be combined with Pacific Interior™ to create a complete curved-face design solution for both the exterior and the interior of a facility.

- Durable aluminum construction
- Front-loading interchangeable aluminum panels
- Mounting: wall, center post, monolith, suspended, projecting
- Installation: direct burial, flange mount
- Wide range of custom and standard colors available
- Graphics: LTV series vinyl graphics or direct UV cured digitally printed graphics
- ISO 9001 manufacturing process
- Two year warranty on parts and labor



The Pacific Exterior™ signage system is a durable, modular solution, which ensures that the system can be easily updated or repaired. The components can also be easily disassembled and sorted into appropriate recycling processes at end-of-life.



# Modular Signage Solutions

## Standard Features and Options

- Panel finish: 140 standard paint colors, one per panel with multiple and custom colors available
- Post finish: gray metallic
- Graphic method: LTV series vinyl graphics or direct UV cured digitally printed graphics

## Tensioned Panel Monolith

- Panels: 0.046" (1.25 mm) tensioned aluminum, concealed welded studs
- Structure: aluminum plate, center post with extruded aluminum panel supports
- Monolith with decorative base reveal or center post and panel appearance available
- Mounting options: monolith or five standard ground clearances
- Installation method: flange mounted only

## Tensioned Panel Wall Mounted Sign

- Panels: tensioned aluminum, concealed welded studs
- Structure: extruded aluminum wall rails
- Mounting: extruded aluminum wall rails
- Installation method: mechanically attached wall rails

## Curved Aluminum Wall Mounted Sign

- Panels: 0.125" (3 mm) rolled aluminum plate, concealed welded studs
- Attachment: extruded and cast aluminum as required
- Mounted wall fittings: mechanically attached wall fittings

## Post and Curved Aluminum Panel Sign

- Panels: 0.125" (3 mm) rolled aluminum plate, concealed welded studs
- Attachment: extruded and cast aluminum as required
- Mounting: single and double sided post mounted
- Installation: ground sleeve or flange mounted

## Projecting Sign

- Panels: 0.125" (3 mm) rolled aluminum plate, concealed welded studs
- Structure: two aluminum brackets and projecting wall fittings
- Mounted: double-sided on projecting fittings
- Installation: projecting wall fittings mechanically attached to wall

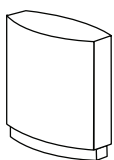

Monolith

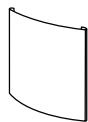

Wall Mount

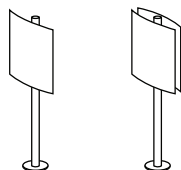

Post and Panel Signs

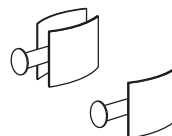

Projecting Signs